

16, Drawwell Street, Belle Vue, Shrewsbury, SY3 7RF
£1,200 Per Month



16, Drawwell Street, Belle Vue, Shrewsbury, SY3 7RF

£1,200 Per Month

VIRTUAL TOUR AVAILABLE: An attractive late Victorian three bedroom semi-detached house of character situated in Belle Vue, close to Shrewsbury town centre.

Available: Immediately

Description

Comprising: Entrance hall, living room, kitchen/dining room including oven & hob, good sized cellar, three bedrooms, bathroom including shower, gas fired central heating, front and good sized private rear gardens. On street parking. EPC D



Unfurnished

Council Tax Band: D

Available: 28th November 2025

EPC: D



Floor Plans

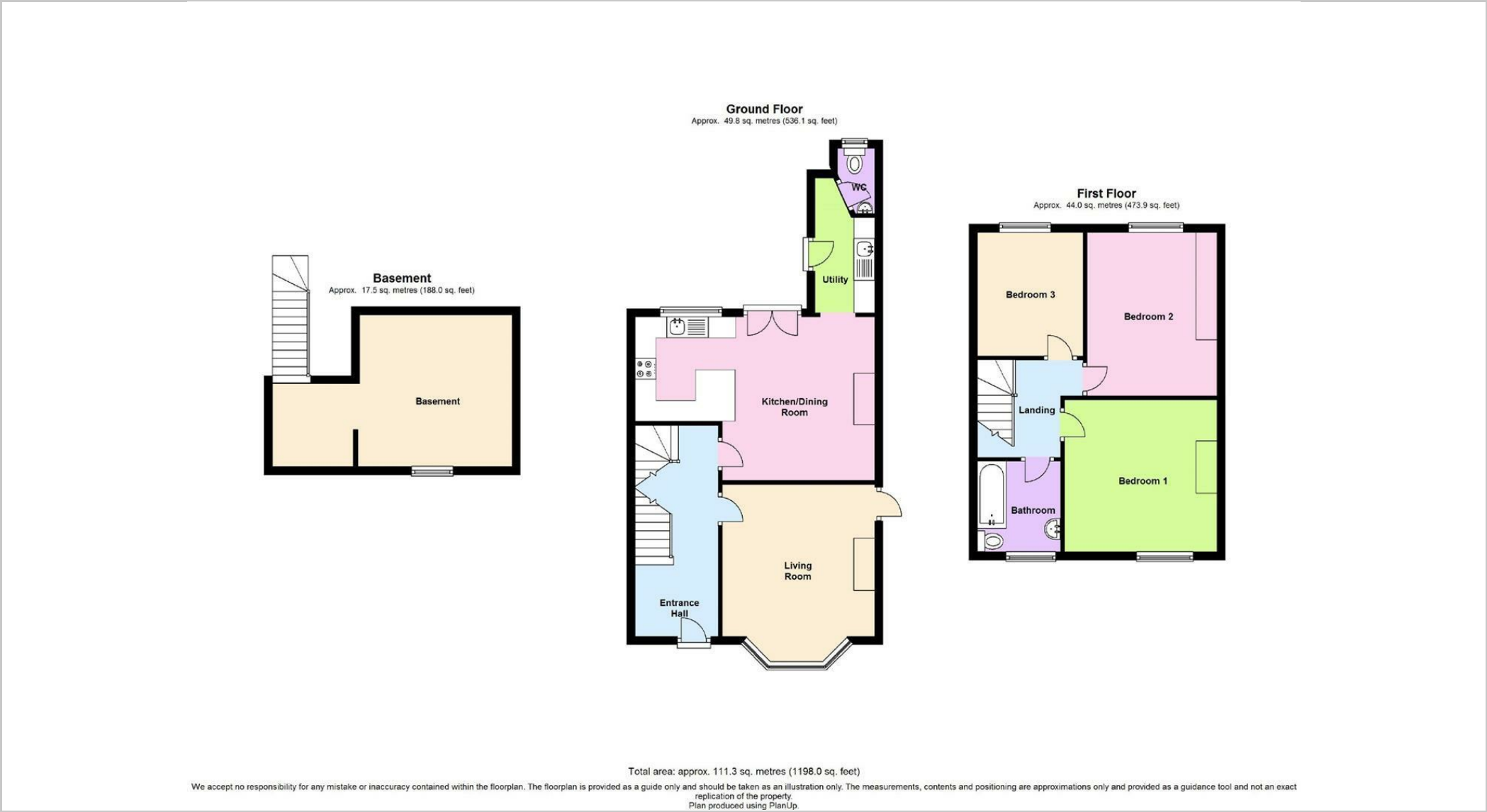

These particulars, whilst believed to be accurate are set out as a general outline only for guidance and do not constitute any part of an offer or contract. Intending purchasers should not rely on them as statements of representation of fact, but must satisfy themselves by inspection or otherwise as to their accuracy. No person in this firms employment has the authority to make or give any representation or warranty in respect of the property.